



# COUNTY HIGHWAY S EAST FRONTAGE ROAD TO WIS 31

## Project Update July 2, 2021



Kenosha County, in partnership with Wisconsin Department of Transportation (WisDOT), is underway with reconstructing County Highway S from the Interstate 94 East Frontage Road to WIS 31, with scheduled completion in late fall 2021.

### WORK COMPLETED TO DATE:

- Westbound lanes have been constructed and lower lifts of asphalt have been placed
- Box culvert extension and new wingwalls constructed on both sides of the Pike River crossing
- New bridge constructed over Canadian Pacific Railway
- New bridge constructed over Kilbourn Ditch
- New at-grade crossing constructed at Union Pacific Railway
- Grading and base aggregate for multi-use path
- County Highway H widening has been completed with asphalt placed
- Grading work on eastbound lanes has been completed

### WORK REMAINING:

- Complete final storm sewer installations near 84th Avenue
- Complete areas of grading west of Union Pacific Railway
- Complete curb and gutter from Union Pacific Railway east to Brumback Boulevard
- Complete median work at Brumback Boulevard
- Asphalt paving eastbound lanes from County Highway H to Brumback Boulevard
- Asphalt paving remaining gaps in multi-use path
- Signalized intersections at Amazon, County Highway H, and Brumback Boulevard
- Pedestrian signals at WIS 31 (Green Bay Road)
- Asphalt paving surface lift throughout the project

Please note that all work is weather dependent and subject to change

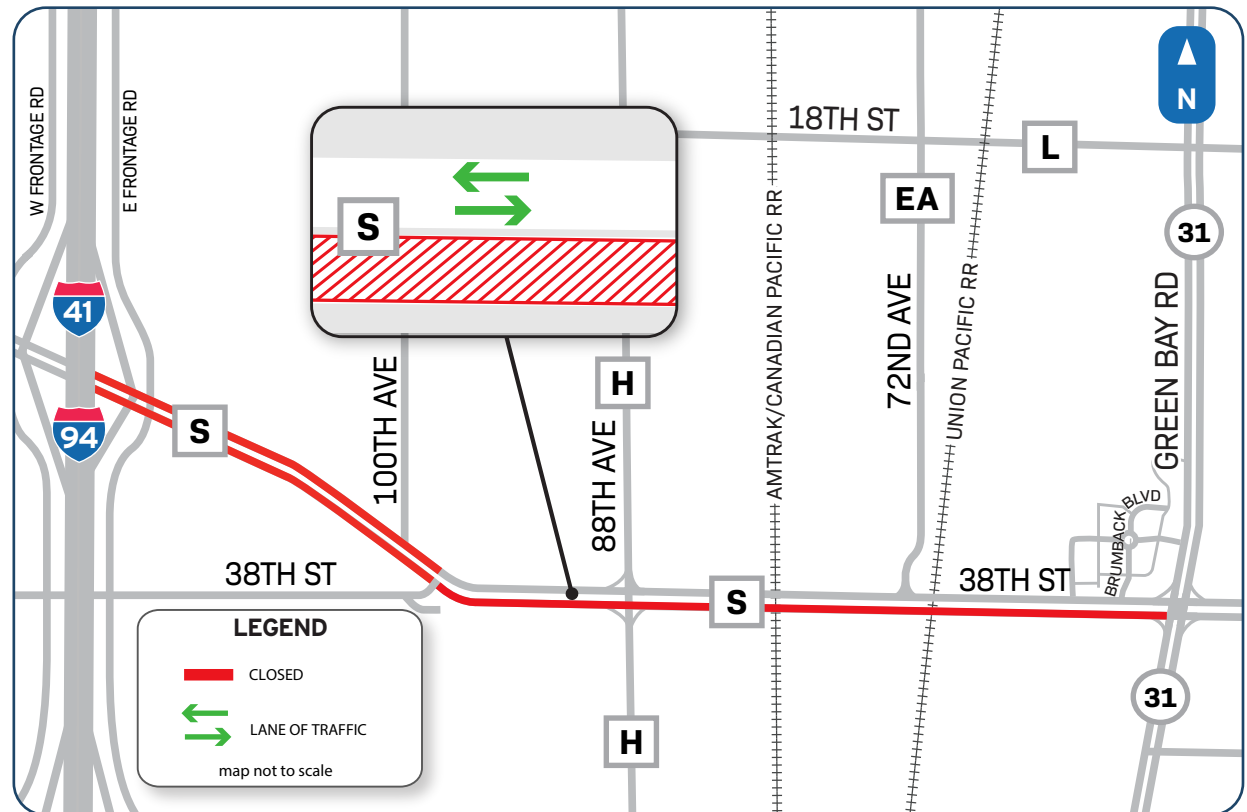

The project team thanks you for your patience and cooperation throughout this project!



Find us on Facebook at:  
Kenosha County  
Government



Find us online at:  
Kenosha County Highways

Project Contact: Rachel Andreoli  
Public Involvement Lead  
Cell: (262) 977-0234  
Email: Rachel@devopr.com

